

COVENTRY™

Sterile Flocked & Foam Sampling Swabs



Efficient, Repeatable & More Comfortable Sampling Swabs for COVID-19, etc.

Coventry™ Sterile Sampling Swabs have been engineered to efficiently collect biological fluids for elution and analysis especially nasopharyngeal and oropharyngeal sampling.

Sampling Swabs are ETO sterilized – free from human DNA, enzymes that degrade DNA and RNA, and polymerase chain reaction inhibitors.

Swab heads are available with either flocked or foam material. Brush-like flocked microfiber swabs are more comfortable, soft, and absorbent with high surface area for rapid capillary absorption of fluid specimens.

Coventry Sterile Sampling Swabs provide more consistent and repeatable sample collection to drastically reduce resampling.

Factory Certificates available:

- FDA Registered
- ISO13485:2016 since 2018 (TÜV Rheinland)
- EC Certificate Dir 93/42/EEC Annex V
- Made for COVENTRY™ by Miraclean

For more information contact our Technical Hotline at 770.424.4888 ext. 137 or AskChemtronics@chemtronics.com. Call 800-645-5244 ext. 154 to schedule an in-house evaluation with a local sales representative.

 **Chemtronics®**
Nothing Performs Like Chemtronics

www.chemtronics.com
8125 Cobb Center Dr. Kennesaw, GA 30152
770-424-4888 | 800-645-5244
askchemtronics@chemtronics.com



Coventry™ Sterile Sampling Swab have been engineered to efficiently collect biological fluids for elution and analysis especially nasopharyngeal and oropharyngeal sampling. Flocked nylon or foam head construction is comfortable, soft, flexible and absorbent.

CLEANLINESS

- Sterilization: ETO
- Free from...
 - Human DNA
 - Enzymes that degrade DNA and RNA
 - Polymerase chain reaction inhibitors

STERILE FLOCKED SWABS

- Head: Nylon Microfiber
- Handle: Polystyrene or ABS
- Microfiber provides high surface area for rapid capillary absorption of fluid specimens.
- Flocking (brush-like nylon fibers) ideal for sample collection from irregular surfaces.
- Head material structure is linear and open, which facilitates rapid absorption and thorough release of specimen into analyzing solution.



66000ST Flocked Swab



66010ST Flocked Swab

STERILE FOAM SWABS

- Head: Polyurethane foam
- Handle: Polystyrene or ABS
- 100 ppi reticulated foam structure for maximum absorption
- Foam cell structure is open, which facilitates rapid absorption and thorough release of specimen into analyzing solution.

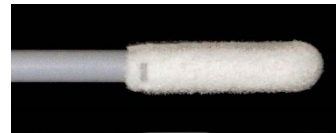

66120ST Foam Swab

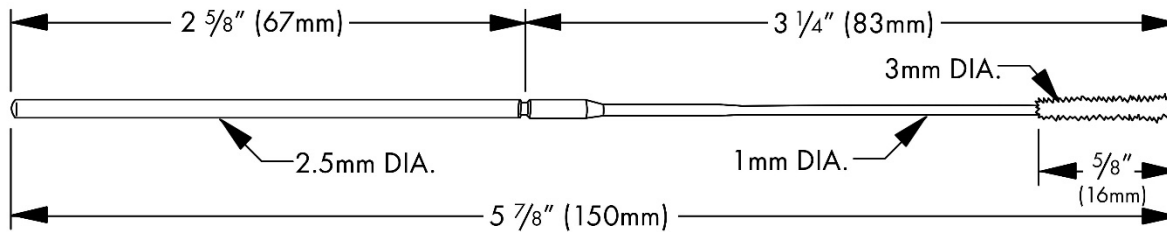
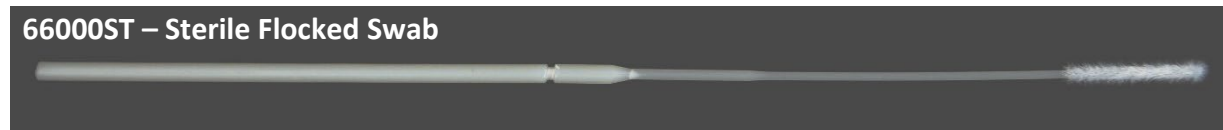

Head

Diameter: 3 mm

Length: 0.625 inches (16 mm)

Handle

Diameter of Grip End: 2.5 mm

Length of Tip End: 3.0 inches (76 mm)

Length of Grip End: 2.625 inches (67 mm)

Neck / Break Point: 3.25 Inches (83 mm) from tip

Diameter of Tip End: ~1.0 mm

Overall Length: 5.875 inches (~150 mm)

66010ST – Sterile Flocked Swab

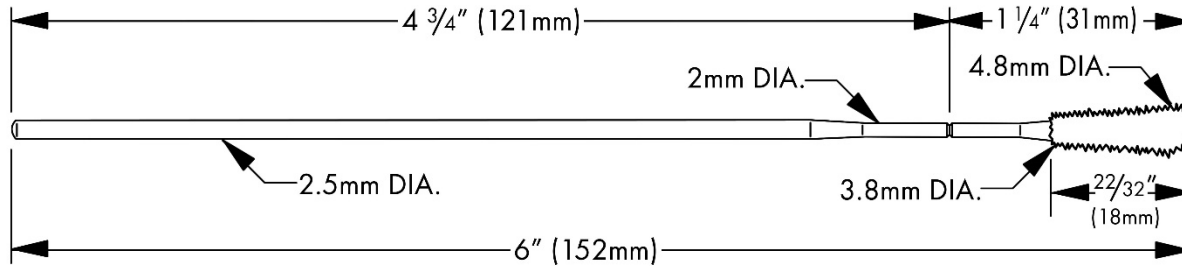

Head

Diameter:	3.8-4.8 mm	Length:	0.71 inches (18 mm)
-----------	------------	---------	---------------------

Handle

Diameter of Grip End:	2.5 mm	Length of Tip End:	2 inches (51 mm)
Length of Grip End:	4.75 inches (121 mm)	Neck / Break Point:	1.22 Inches (31 mm) from tip
Diameter of Tip End:	2 mm	Overall Length:	6 inches (152 mm)

66120ST – Sterile Foam Swab

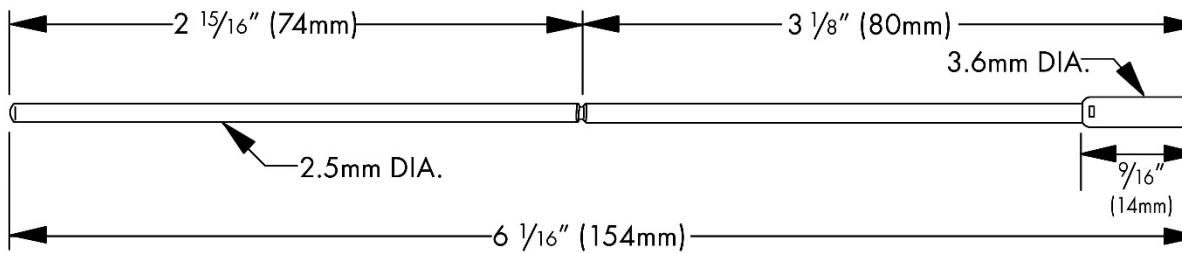

Head

Diameter:	3.6 mm	Length:	0.55 inches (14 mm)
-----------	--------	---------	---------------------

Handle

Diameter of Grip End:	2.5 mm	Length of Tip End:	n/a
Length of Grip End:	2.91 inches (74 mm)	Neck / Break Point:	3.15 Inches (80 mm) from tip
Diameter of Tip End:	2.5 mm	Overall Length:	6.06 inches (154 mm)

PACKAGING

100 swabs/inner bag, 500 swabs (5 inner bags)/outer bag,
2500 swabs (5 outer bags)/case

Coventry Sampling Swabs come in individually sterile packaged. Each package is lot coded for quality control traceability.



The back of each package contains brief instructions.

Transport vial not included.

BREAK POINT

Handles are scored for easy breaking for insertion into the transport vial.



DIRECTIONS FOR USE

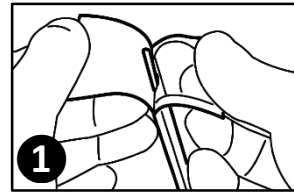

Step 1 – Peel apart the handle-side of the package.

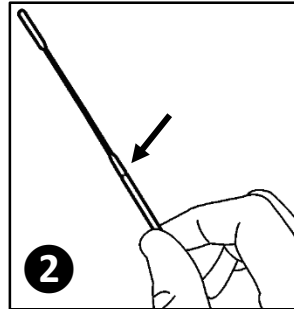

Step 2 – When removing and using the sterilized swab, only grip it below the breakpoint to prevent contamination of the sample.

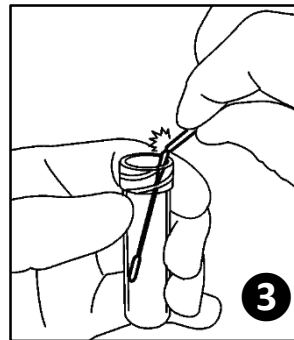

Step 3 – Insert the swab into the transport medium and break the handle at the breakpoint after sampling.

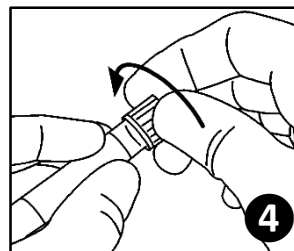

Step 4 – Tighten the cap to secure. Label vial and deliver sample to lab for testing.

NOTE:

This information is believed to be accurate. It is intended for professional end users having the skills to evaluate and use the data properly. Chemtronics does not guarantee the accuracy of the data and assumes no liability in connection with damages incurred by using it., Chemtronics, Coventry are registered trademarks and all rights are reserved. All rights reserved.



www.chemtronics.com

8125 Cobb Center Dr. Kennesaw, GA 30152

770-424-4888 | 800-645-5244

askchemtronics@chemtronics.com

TECHNICAL & APPLICATION ASSISTANCE

Chemtronics provides a technical service hotline to answer you technical and application related questions. The toll free number is: 1-800-TECH-401 (1-800-832-4401).